

HUNTERS®

HERE TO GET *you* THERE

16 Howell Close, Arborfield, Reading, RG2 9QN

Offers In Excess Of £310,000

Property Images



HUNTERS®

HERE TO GET *you* THERE

Property Images



HUNTERS[®]

HERE TO GET *you* THERE

Property Images

HUNTERS®

HERE TO GET *you* THERE

GROUND FLOOR

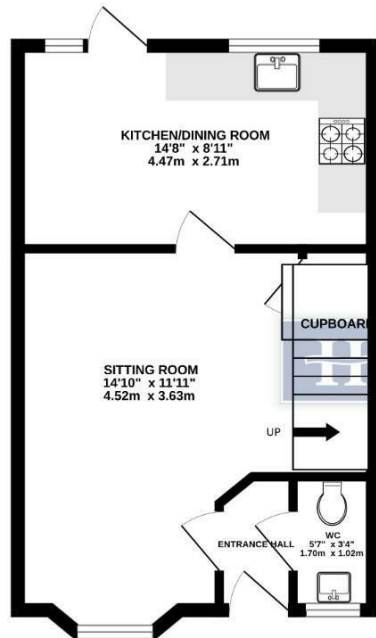

1ST FLOOR

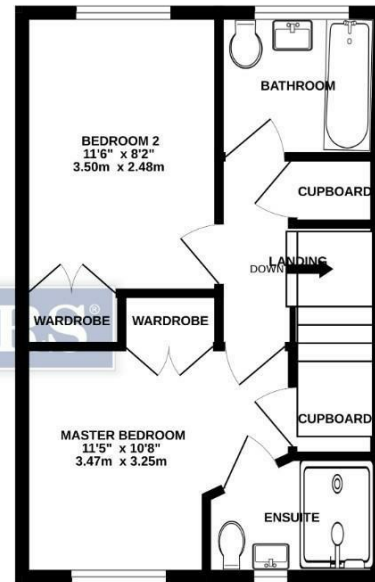

Measurements are approximate. Not to scale. Illustrative purposes only.
Made with Metropix ©2023

EPC

Energy Efficiency Rating		
	Current	Potential
Very energy efficient - lower running costs		
(92 plus) A		85
(81-91) B		
(69-80) C	72	
(55-68) D		
(39-54) E		
(21-38) F		
(1-20) G		
Not energy efficient - higher running costs		
England & Wales EU Directive 2002/91/EC		

Map

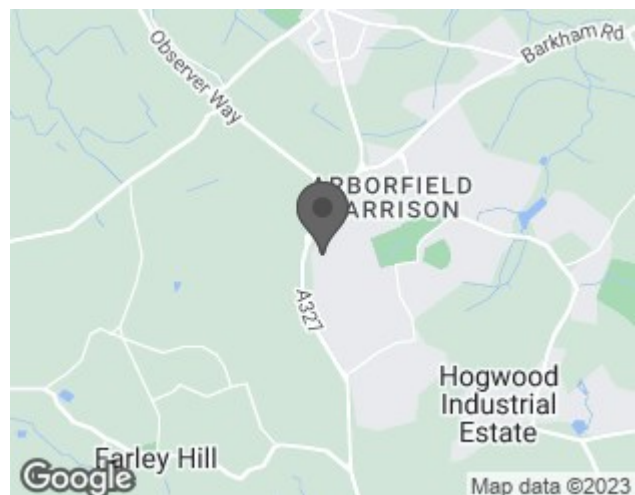

Details

Type: House - End Terrace Beds: 2 Bathrooms: 2 Receptions: 1 Tenure: Freehold

Summary

Hunters Estate Agents are please to present this well maintained two bedroom end of terrace home in the sought after village location of Arborfield. The accommodation comprises entrance hall, cloakroom, living room, kitchen/dining room, family bathroom, en suite shower room to master bedroom, private rear garden and two allocated parking spaces.

The location is ideal as it gives easy access to Wokingham and Reading, both with rail connections to either London Waterloo or London Paddington. The village itself has a few local shops including a Co Op supermarket which has only recently been built. For tenants with children both primary and secondary schools are close by. No onward chain. Viewings are highly recommended

Features

- End terrace house • Two double bedrooms • Living room • Kitchen/dining room • Family bathroom • Ensuite to master bedroom • Double glazed and central heating • Private enclosed rear garden • Allocated parking spaces • Cloakroom